

Exhibit Halls ABCDEF
Floor Loads: 125 PSF



Exhibit Level North/South

Disclaimer:
This drawing is intended as a guide only.
The Moscone Center/SMG cannot be held
responsible for on-site variations or
adjustments.

11 10 2021

Hang Point Locations & Ratings

HALLS A, B, AND C:

Each eyebolt is rated at 2,000 lbs straight down. Rating decreases when bridle. Brides between 45° and 90° may not exceed 500 lbs.

This drawing is the T-Bracket hang point on the inside face of the arches:

Capacity=
Down: 1,000 lbs
Away: 500 lbs
Side: 125 lbs

These points occur on the rigging gridlines at 4&5, 9&10, 14&15, 19&20, 24&25, 29&30, 34&35, 39&40. Refer to Arch Elevation for typical height and placement.

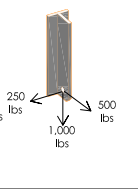

Hall A East and Hall C East have sloped ceilings requiring a Special Height Notice:

Hall A East:

Gridline 2= 27'-0"

Gridline 3= 35'-3"

Hall C West:

Gridline 41= 35'-3"

Gridline 42= 27'-0"

Gridline 43= 18'-9"

HALL D:

5,000 lbs vertical down in any direction.
2,500 lbs Horizontal in any direction.

HALL E:

1,000 lbs per eyebolt straight down.
NO BRIDLES ALLOWED.

LOBBIES:

All Lobbies are rated at 1,000 lbs straight down. There will be no bridges or side loads permitted in any lobbies.

Any rigging over 1,000 lbs should have plans available upon request from the house rigger to review.

Aisle sign cables rated at 25 lbs per span between eyebolts.

Please report any eye bolts that are bent or show defects of any kind to event manager or house rigger.

It is the responsibility of all persons designing or using hang points to read and understand the house rules, policies and procedures for rigging at Moscone Center.

HALL F:

2,000 lbs on eyebolts straight down. Ratings decrease when bridling. Brides between 45° and 90° may not exceed 500 lbs.

= Saddle Bracket. Maintains 2,000 lbs capacity. Points are designated with an asterisk next to grid name (M4.1*, for example).

= T Bracket. Maintains 2,000 lbs capacity. Points are designated with a double asterisk next to grid name (M4.7**, for example).

HALL F Exceptions:



COLUMN ANCHORS 25 lbs.

= Hangpoints AA1-AA13 and 21-213 are designed as cable paths and are rated at 200lbs.

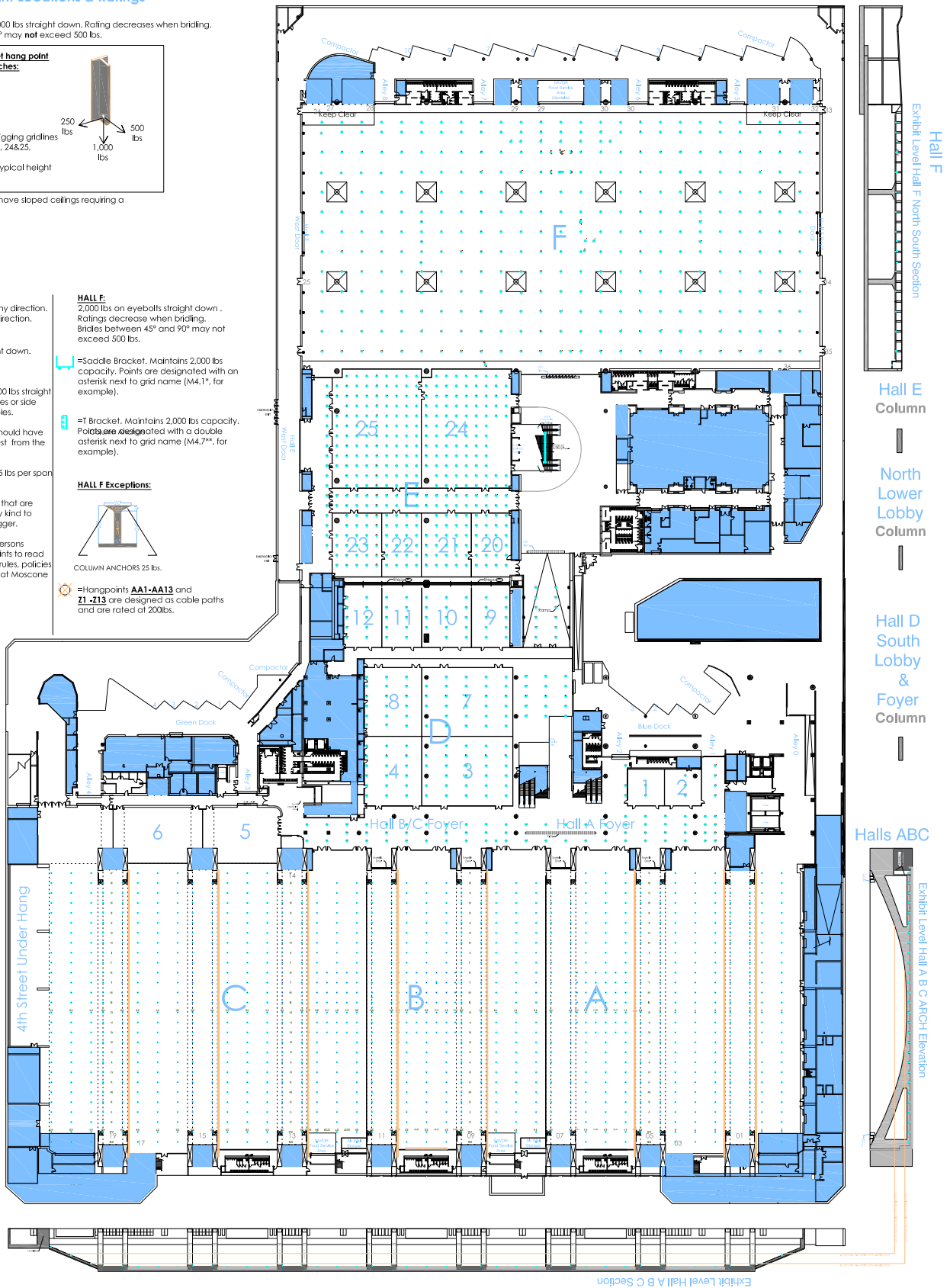

Exhibit Halls ABCDEF
Floor Loads: 125 PSF



Exhibit Level North/South Rigging

Disclaimer:

This drawing is intended as a guide only. The Moscone Center/SMG cannot be held responsible for on-site variations or adjustments.

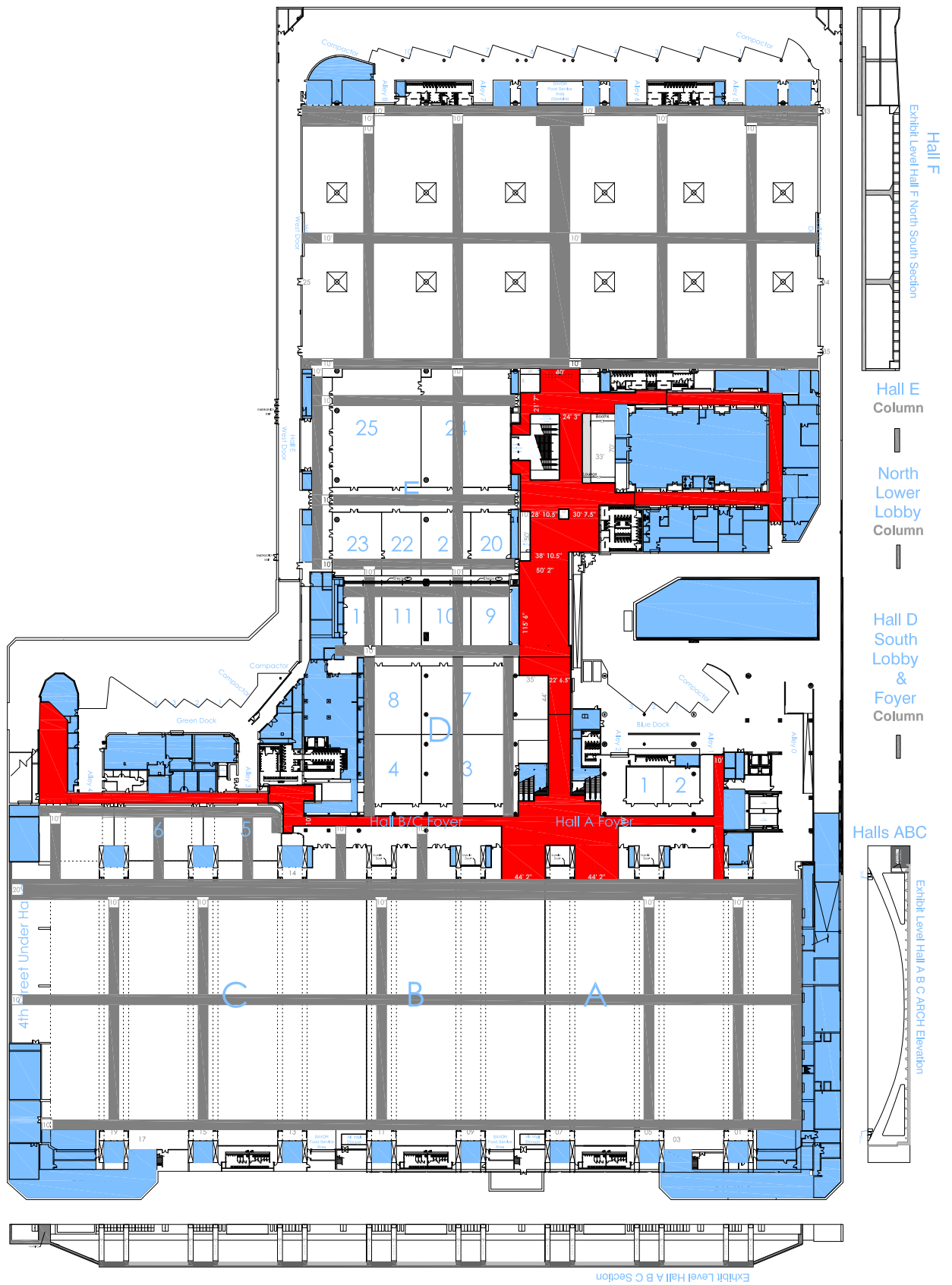

Exhibit Halls ABCDEF
Floor Loads: 125 PSF



Exhibit Level North/South Keep Clear

Disclaimer:

This drawing is intended as a guide only. The Moscone Center/SMG cannot be held responsible for on-site variations or adjustments.

11 10 2021

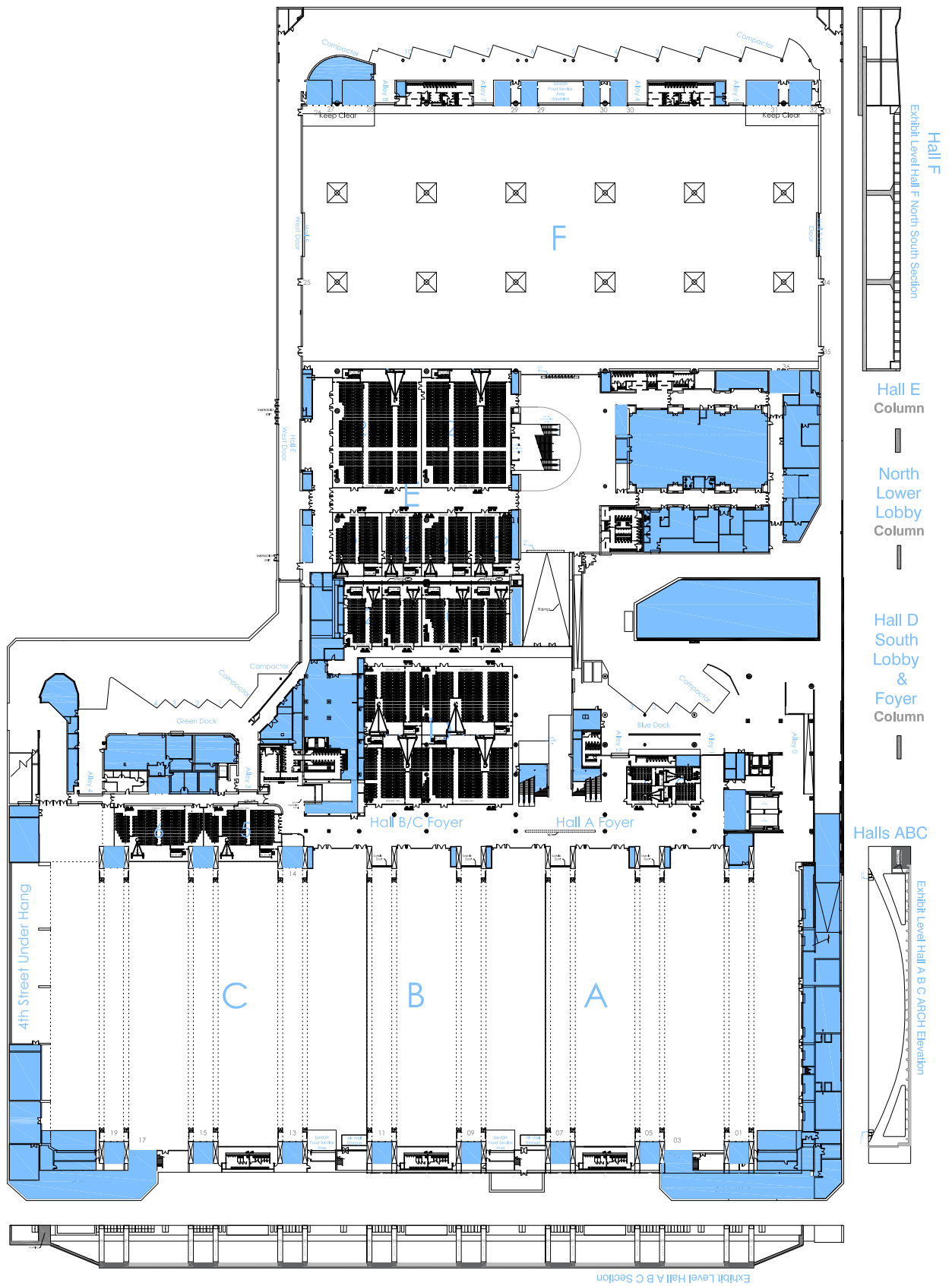

Exhibit Level North/South Theater

Disclaimer:
This drawing is intended as a guide only.
The Moscone Center/SMG cannot be held
responsible for on-site variations or
adjustments.

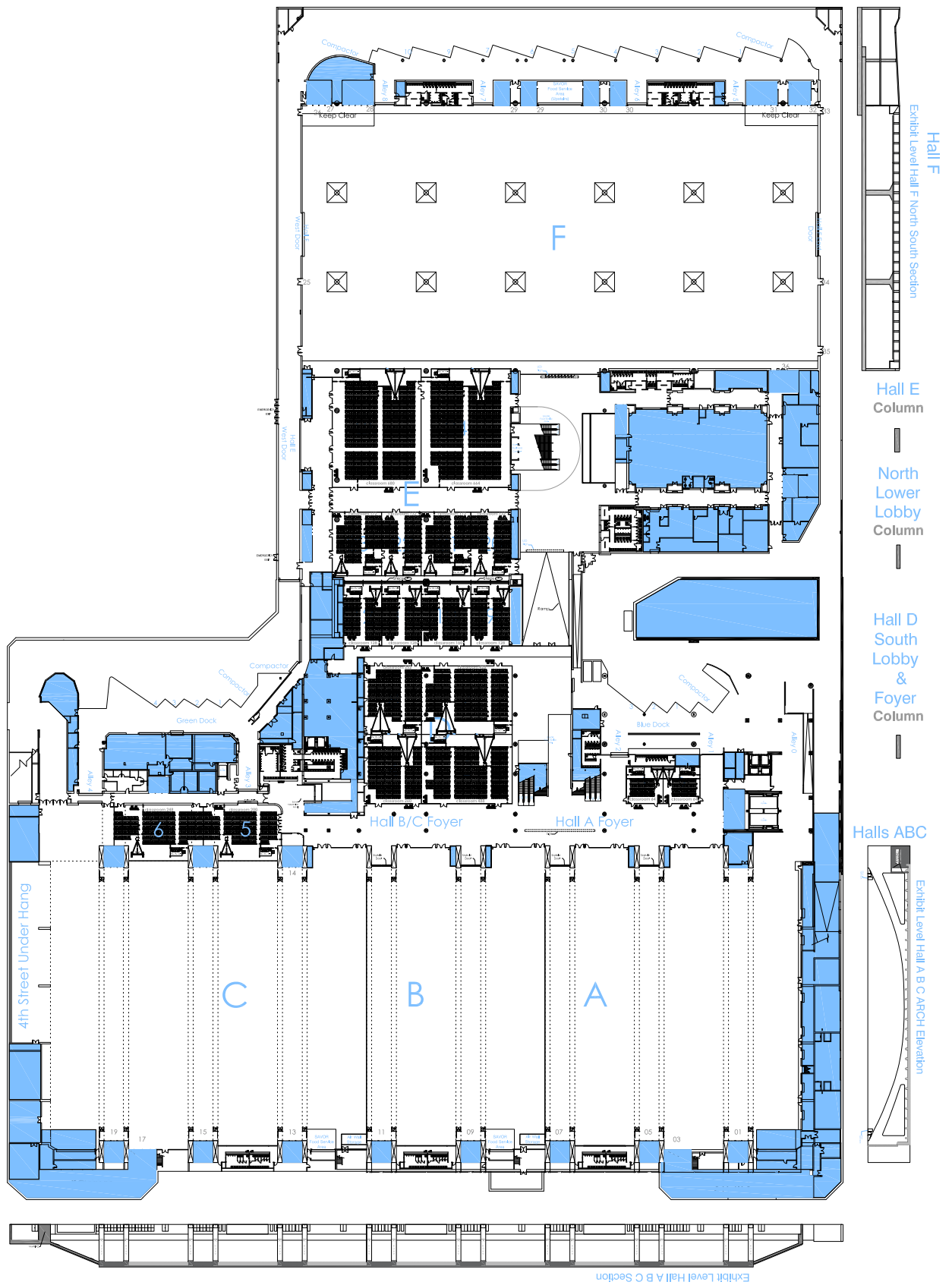

Exhibit Halls ABCDEF
Floor Loads: 125 PSF



Exhibit Level North/South Classroom

Disclaimer:
This drawing is intended as a guide only.
The Moscone Center/SMG cannot be held
responsible for on-site variations or
adjustments.

11 10 2021